



GENERAL INFORMATION

“HOTEX GL PLUS ELECTRIC WATER HEATERS” - A clear winner with great looks and matching performance.

Note:

- Single weld Steel Boiler: The thick steel boiler provides strength, while the extra thick inert glass coating provides protection against corrosion. This ensures clean and hygienic water for years.
- Magnesium Anode: Extra large size and easily replaceable. Provides Cathodic protection inside the boiler. It is attacked by the dissolved salts in water and is “sacrificed” in preference to the boiler body. This arrests corrosion and further enhances the life of the boiler.
- Heating Element: Flange type, easy to replace. The large flange opening ensures superior cleaning and uniform enameling, resulting in longer life. It also facilitates easy cleaning and maintenance during use. (Wattage: 1.6-1.8 & 2.1-2.4 kW)
- Gasket: Made from superior rubber to withstand higher temperature & pressure for a longer time.
- Testing: Every heater is checked for electricals and leakage. The Test Pressure is twice that of the Rated Pressure.



**“HOTEX” GL PLUS
THE FIT AND FORGET WATER HEATER**

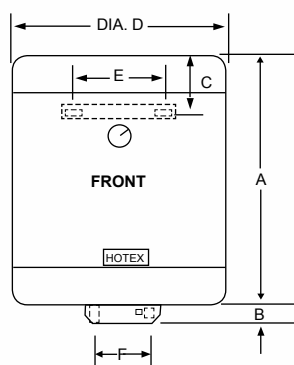

VERTICAL WALL MOUNTING “EP” SERIES

MODEL NOS.		EP030BB	EP050BB	EP080BB	EP100BB
CAPACITY IN LTS.		30	50	80	100
DIMENSIONS (MM)	A	430	580	680	820
	B	45	45	45	45
	C	155	155	175	175
	D	400	400	450	450
	E	265	265	265	265
	F	100	100	100	100
NET WEIGHT (KGS.)		14.1	19.7	26.4	28.5
RATED INPUT-KW		1.6-1.8		2.1-2.4	
RATED PRESSURE		0.75 MPa			
POWER SUPPLY		Single Phase			
HEAT INSULATION		Polyurethane Form			
I/O SIZE-B.S.P.T		1/2"			
I/O POSITION		Bottom			

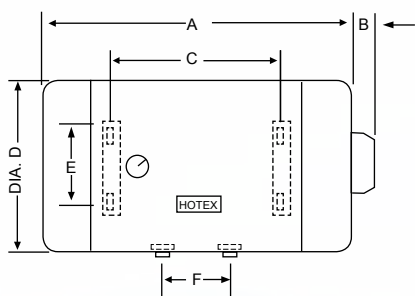

HORIZONTAL WALL MOUNTING “FP” SERIES

Model Nos.		FP030BB	FP050BB	FP080BB	FP100BB
Capacity in Lts.		30	50	80	100
Dimensions (mm)	A	430	450	680	820
	B	45	45	45	45
	C	160	200	360	500
	D	400	450	450	450
	E	265	265	265	265
	F	150	150	150	150
Net Weight (Kgs.)		14.1	19.7	26.4	28.5
Rated Input-kW		1.6-1.8		2.1-2.4	
Rated Pressure		0.75 MPa			
Power Supply		Single Phase			
Heat Insulation		Polyurethane Form			
I/O Size-B.S.P.T		1/2"			
I/O Position		Bottom			



“HOTEX” GL PLUS
THE FIT AND FORGET WATER HEATER

VERTICAL WALL MOUNTING “ EX ” SERIES

MODEL NOS		EX050BB	EX100BB
Capacity in Ltrs		50	100
Dimension in mm	A	500	900
	B	50	50
	C	180	165
	D	450	450
	E	265	265
	F	100	100
APPROX.WEIGHT IN KG		22	33
RATED INPUT-kW		1.6-1.8	2.1-2.4
RATED PRESSURE		0.75 MPa	
POWER SUPPLY		220-240V	
HEAT INSULATION		Polyurethane Form	
I/O SIZE BSPT		1/2"	
I/O POSITION		Bottom	

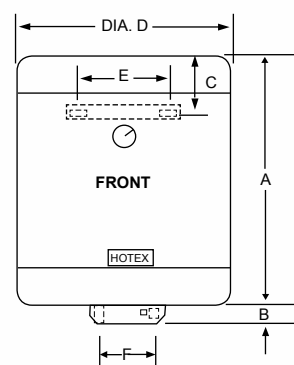

HORIZONTAL WALL MOUNTING “ FX ” SERIES

MODEL NOS		FX050BB	FX100BB
Capacity in Ltrs		50	100
Dimension in mm	A	500	880
	B	50	50
	C	200	500
	D	450	450
	E	265	265
	F	160	160
APPROX.WEIGHT IN KG		22	33
RATED INPUT-kW		1.6-1.8	2.1-2.4
RATED PRESSURE		0.75 MPa	
POWER SUPPLY		220-240V	
HEAT INSULATION		Polyurethane Form	
I/O SIZE BSPT		1/2"	
I/O POSITION		Bottom	

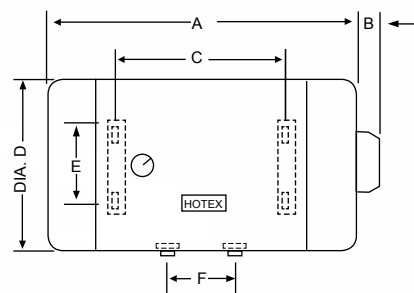

HOTEX GLASS LINED XTRA
EXTRA HOT ON FEATURES, COOL ON PRICE

VERTICAL WALL MOUNTING “ EC ” SERIES

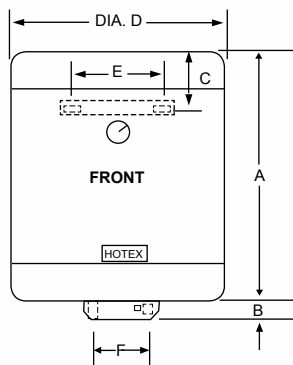

MODEL NOS		EC050BB	EC100BB
Capacity in Ltrs		50	100
Dimension in mm	A	500	900
	B	50	50
	C	180	165
	D	450	450
	E	265	265
	F	100	100
APPROX.WEIGHT IN KG		22	23
RATED INPUT-kW		1.6-1.8	2.1-2.4
RATED PRESSURE		0.75 MPa	
POWER SUPPLY		220-240V	
HEAT INSULATION		Polyurethane Form	
I/O SIZE BSPT		1/2"	
I/O POSITION		Bottom	

HORIZONTAL WALL MOUNTING “ FC ” SERIES

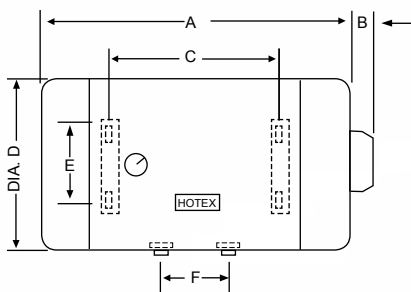

MODEL NOS		FC050BB	FC100BB
Capacity in Ltrs		50	100
Dimension in mm	A	500	880
	B	50	50
	C	200	500
	D	450	450
	E	265	265
	F	160	160
APPROX.WEIGHT IN KG		22	33
RATED INPUT-kW		1.6-1.8	2.1-2.4
RATED PRESSURE		0.75 MPa	
POWER SUPPLY		220-240V	
HEAT INSULATION		Polyurethane Form	
I/O SIZE BSPT		1/2"	
I/O POSITION		Bottom	



HOTEX GLASS LINED XTRA
EXTRA HOT ON FEATURES, COOL ON PRICE